

ORDINANCE BILL NO. 5 FOR 2009

ORDINANCE NO. 1213

AN ORDINANCE VACATING PORTIONS OF THE PUBLIC RIGHT-OF-WAYS IDENTIFIED ON 54TH AVENUE, 55TH AVENUE, LARCH STREET, AND LOCUST STREET, ALL WITHIN THE CITY OF SWEET HOME, LINN COUNTY, OREGON.

WHEREAS, the City Council has initiated the vacation proceedings on its own motion, and has had notice provided, as required by ORS Chapter 271; and,

WHEREAS, the Planning Commission was given an opportunity to review the proposed vacation and has made a recommendation to the City Council to approve the Vacation with amendments; and,

WHEREAS, no objections have been received to said proposed Vacation; and,

WHEREAS, no substantial effect to the market value of the property has been identified; and,

WHEREAS, the City Council has determined that no public interests will be prejudiced by the Vacation;

NOW, THEREFORE, THE CITY OF SWEET HOME DOES ORDAIN AS FOLLOWS:

Section 1. That the public right-of-ways in the City of Sweet Home, Linn County, Oregon, are vacated as depicted on the map titled Exhibit "A" and the descriptions of the vacated areas as set forth in Exhibits "B through AD" attached hereto and by this reference incorporated herein.

Section 2. The City Recorder shall file with the County Recorder a certified copy of this ordinance, with copies also filed with the County Assessor and County Surveyor, as required by ORS Chapter 271.

PASSED by the City Council and approved by the Mayor this 22nd day of September, 2009.



Mayor

ATTEST:



City Manager - Ex Officio City Recorder

City of Sweet Home Roadway Vacation of 55th Avenue Area Right-of-Ways.

Exhibit A

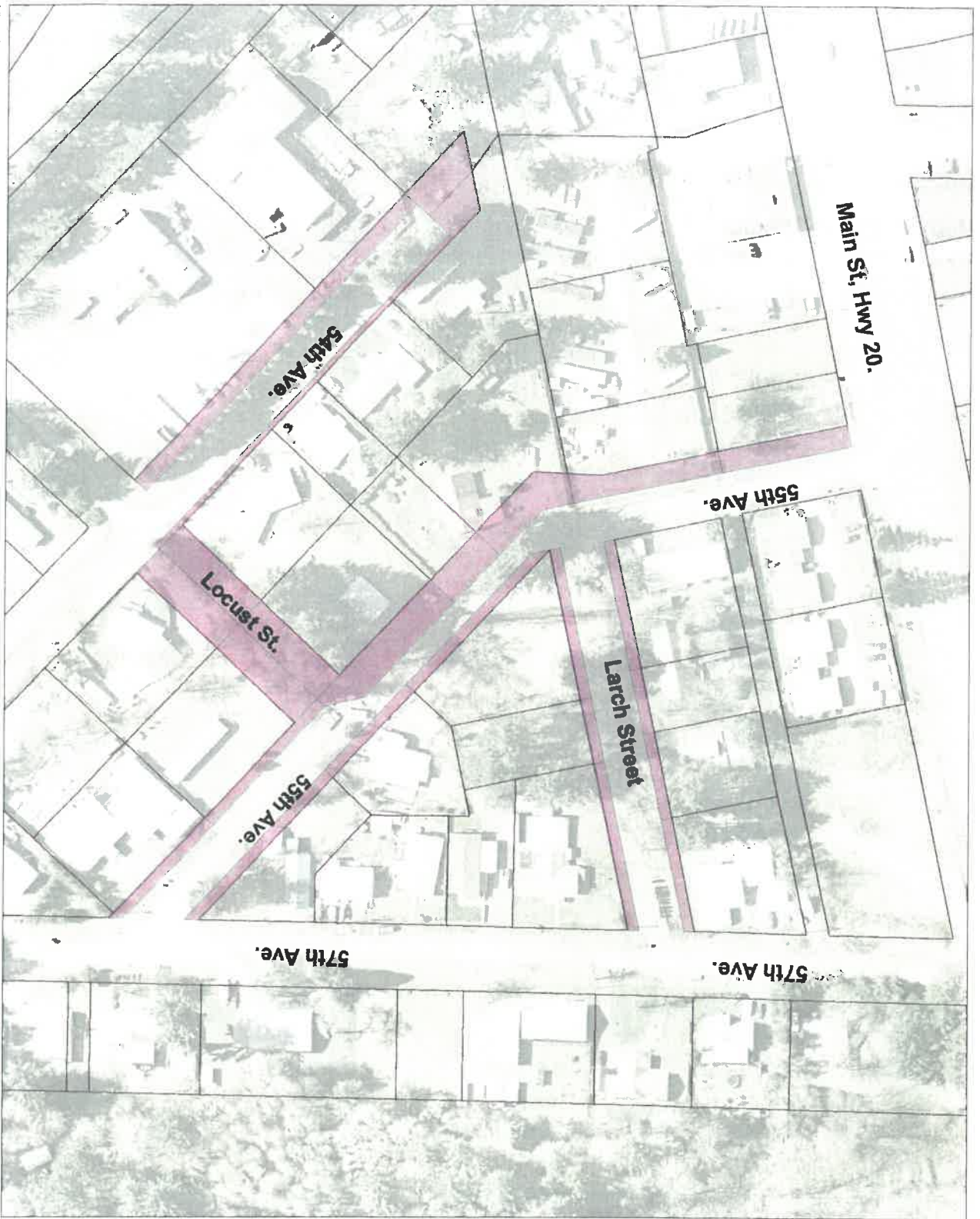

55th Ave:
Constant Width, 20 ft west side, 60 ft to 40 ft.
Main St to Larch St.
20 ft Alley, Larch St to Locust St.
Constant Width, 10 ft both sides, 60 ft to 40 ft.

54th Ave:
Full Width 60 ft to 0 ft.
North End off Locust St.
Constant Width, 15 ft west side
& 5 ft east side, 60 ft to 40 ft.
North End to Locust St.

Locust St.:
Full Width 60 ft to 0 ft.
54th Ave to 55th Ave.

Larch St.:
Constant Width, 10 ft both sides, 60 ft to 40 ft.
54th Ave to 57th Ave.



1 in = 40 ft July 21, 2009

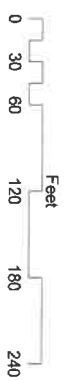

Legend



-  Vacated Areas of Right-of-Ways
-  Property Lines 2009

Exhibit B

Vacated area of 55th Avenue (formerly Ash Street), Sweet Home, Oregon.
Related to property Map 13S01E27DB, Lot 02600

A portion of land located in the Northwest $\frac{1}{4}$ of the Southeast $\frac{1}{4}$ of Section 27, Township 13 South, Range 1 East, Willamette Meridian, City of Sweet Home, Linn County, Oregon, more particularly described as follows:

Beginning at a point on the northeast corner of Lot 5, Block 16, of the Scholl's Addition to Foster, Linn County, Oregon, a subdivision in the City of Sweet Home, Linn County, Oregon, said point also being the intersection of the west right-of-way of 55th Avenue and the south right-of-way of US Highway 20 (Santiam Highway); thence North $76^{\circ} 53'$ East 20.0 feet along the south line of US Highway 20 to a point; thence South $13^{\circ}07'$ East 120.0 feet parallel to the west line of 55th Avenue to a point; thence South $76^{\circ} 53'$ West 20.0 feet to a point on the west right-of-way of 55th Avenue, said point being South $13^{\circ}07'$ East 10.0 feet the southeast corner of Lot 5, Block 16, of said subdivision; thence North $13^{\circ}07'$ West 120.0 feet along the west line of 55th Avenue to the point of beginning.

Containing 2,400 square feet.

Together with an easement for public utilities described as follows:

Beginning at a point on the northeast corner of Lot 5, Block 16, of the Scholl's Addition to Foster, Linn County, Oregon, a subdivision in the City of Sweet Home, Linn County, Oregon, said point also being the intersection of the west right-of-way of 55th Avenue and the south right-of-way of US Highway 20 (Santiam Highway); thence North $76^{\circ} 53'$ East 20.0 feet along the south line of US Highway 20 to a point; thence South $13^{\circ}07'$ East 15.0 feet parallel to the west line of 55th Avenue to a point; thence South $76^{\circ} 53'$ West 20.0 feet to a point on the west right-of-way of 55th Avenue, thence North $13^{\circ}07'$ West 15.0 feet along the west line of 55th Avenue to the point of beginning.

Containing 300 square feet.

Exhibit C

Vacated area of 55th Avenue (formerly Ash Street), Sweet Home, Oregon.
Related to property Map 13S01E27DB, Lot 02700

A portion of land located in the Northwest $\frac{1}{4}$ of the Southeast $\frac{1}{4}$ of Section 27, Township 13 South, Range 1 East, Willamette Meridian, City of Sweet Home, Linn County, Oregon, more particularly described as follows:

Beginning at a point on the southeast corner of Lot 6, Block 16, of the Scholl's Addition to Foster, Linn County, Oregon, a subdivision in the City of Sweet Home, Linn County, Oregon, said point also being at the intersection of the westerly right-of-way of 55th Avenue with the north right-of-way of Fourth Avenue (vacated); thence North $13^{\circ}07'$ West 110.0 feet along the west line of 55th Avenue to a point, said point being North $13^{\circ}07'$ West 10.0 feet from the northeast corner of Lot 6, Block 16 of said subdivision; thence North $76^{\circ} 53'$ East 20.0 feet to a point; thence South $13^{\circ}07'$ East 139.94 feet parallel to the west line of 55th Avenue to a point, said point being on the centerline of Larch Street (formerly Fourth Avenue); thence South $76^{\circ} 53'$ West 28.18 feet along the center line of Larch Street to a point, said point being also the intersection of the west right-of-way line of 55th Avenue with the centerline of Larch Street; thence North $2^{\circ}10'$ East 31.04 feet along the west line of 55th Avenue to the point of beginning.

Containing 2,916.36 square feet.

Exhibit D

Vacated area of 55th Avenue (formerly Ash Street), Sweet Home, Oregon.

Related to property Map 13S01E27DB, Lot 03800

A portion of land located in the Northwest $\frac{1}{4}$ of the Southeast $\frac{1}{4}$ of Section 27, Township 13 South, Range 1 East, Willamette Meridian, City of Sweet Home, Linn County, Oregon, more particularly described as follows:

Beginning at a point on the northeast corner of Lot 1, Block 19, of the Scholl's Addition to Foster, Linn County, Oregon, a subdivision in the City of Sweet Home, Linn County, Oregon, said point also being at the intersection of the westerly right-of-way of 55th Avenue with the south right-of-way of Fourth Avenue (vacated); thence North 2°10' East 31.04 feet along the west line of 55th Avenue to a point on the west line of 55th Avenue, said point also being at the intersection of the westerly right-of-way of 55th Avenue with the centerline of Larch Street (formerly Fourth Avenue); thence North 76°53' East 28.18 feet along the centerline of Larch Street to a point; thence South 13°07' East 29.05 feet to a point, said point also being on the centerline of 55th Avenue South of Larch Street and North 42°02' East 30.00 feet from the southwesterly line of 55th Avenue; thence South 47°58' East 56.41 feet along the centerline of 55th Avenue parallel to the southwesterly line of 55th Avenue to a point, said point being North 42°02' East 30.00 feet from the most easterly corner of said lot 1; thence South 42°02' West 30.00 feet to a point, said point being on the southwesterly line of 55th Avenue; thence North 47°58' West 75.91 feet along the southwesterly line of 55th Avenue to the point of beginning.

Containing 2,924.69 square feet.

Exhibit E

Vacated area of 55th Avenue (formerly Ash Street), Sweet Home, Oregon.
Related to property Map 13S01E27DB, Lot 03900

A portion of land located in the Northwest $\frac{1}{4}$ of the Southeast $\frac{1}{4}$ of Section 27, Township 13 South, Range 1 East, Willamette Meridian, City of Sweet Home, Linn County, Oregon, more particularly described as follows:

Beginning at a point on the most northerly corner of Lot 3, Block 19, of the Scholl's Addition to Foster, Linn County, Oregon, a subdivision in the City of Sweet Home, Linn County, Oregon, said point also being on the southwesterly right-of-way of 55th Avenue; thence North 42°02' East 30.00 feet to a point on the centerline of 55th Avenue; thence South 47°58' East 60.00 feet along the centerline of 55th Avenue to a point; thence South 42°02' West 30.00 feet to a point on the most easterly corner of Lot 3, Block 19, of said subdivision; thence North 47°58' West 60.00 feet to the point of beginning.

Containing 1,800 square feet.

Exhibit F

Vacated area of 55th Avenue (formerly Ash Street), Sweet Home, Oregon.
Related to property Map 13S01E27DB, Lot 04101

A portion of land located in the Northwest $\frac{1}{4}$ of the Southeast $\frac{1}{4}$ of Section 27, Township 13 South, Range 1 East, Willamette Meridian, City of Sweet Home, Linn County, Oregon, more particularly described as follows:

Beginning at a point on the most northerly corner of Lot 4, Block 19, of the Scholl's Addition to Foster, Linn County, Oregon, a subdivision in the City of Sweet Home, Linn County, Oregon, said point also being on the southwesterly right-of-way of 55th Avenue; thence North 42°02' East 30.00 feet to a point on the centerline of 55th Avenue; thence South 47°58' East 120.00 feet along the centerline of 55th Avenue to a point, said point being on the extension of the northwesterly line of Locust Street (formerly Fifth Avenue); thence South 14°17' East 36.06 feet to a point, said point being on the centerline of Locust Street, and North 42°02' East 10.00 feet from the southwesterly line of 55th Avenue; thence South 42°02' West 10.00 feet along the centerline of Locust Street to a point on the southwesterly right-of-way of 55th Avenue; thence North 47°58' West 30.00 feet along the southwesterly line of 55th Avenue to the most easterly corner of Lot 5, Block 19, of said subdivision; thence North 47°58' West 120.00 feet along the southwesterly line of 55th Avenue to the point of beginning.

Containing 4,200 square feet.

Exhibit G

Vacated area of 55th Avenue (formerly Ash Street), Sweet Home, Oregon.
Related to property Map 13S01E27DC, Lot 900

A portion of land located in the Southwest $\frac{1}{4}$ of the Southeast $\frac{1}{4}$ of Section 27, Township 13 South, Range 1 East, Willamette Meridian, City of Sweet Home, Linn County, Oregon, more particularly described as follows:

Beginning at a point on the most northerly corner of Lot 1, Block 22, of the Scholl's Addition to Foster, Linn County, Oregon, a subdivision in the City of Sweet Home, Linn County, Oregon, said point also being the intersection of the southwesterly right-of-way of 55th Avenue with the southeasterly right-of-way of Locust Street (formerly Fifth Avenue); thence South 47°58' East 120.00 feet along the southwesterly line of 55th Avenue; thence North 42°02' East 10.00 feet to a point; thence North 47°58' West 150.00 feet parallel to the southwesterly line of 55th Avenue to a point on the centerline of Locust Street; thence South 42°02' West 10.00 feet along the centerline of Locust Street to a point on the southwesterly line of 55th Avenue; thence South 47°58' East 30.00 feet along the southwesterly line of 55th Avenue to the point of beginning.

Containing 1,500 square feet.

Exhibit H

Vacated area of 55th Avenue (formerly Ash Street), Sweet Home, Oregon.

Related to property Map 13S01E27DC, Lot 800

A portion of land located in the Southwest $\frac{1}{4}$ of the Southeast $\frac{1}{4}$ of Section 27, Township 13 South, Range 1 East, Willamette Meridian, City of Sweet Home, Linn County, Oregon, more particularly described as follows:

Beginning at a point on the most northerly corner of Lot 3, Block 22, of the Scholl's Addition to Foster, Linn County, Oregon, a subdivision in the City of Sweet Home, Linn County, Oregon, said point also being on the southwesterly right-of-way of 55th Avenue; thence South 47°58' East 120.00 feet along the southwesterly line of 55th Avenue to a point, said point being the most easterly corner of Lot 4, Block 22, of said subdivision; thence North 42°02' East 6.54 feet to a point, said point being on the west line of 57th Avenue (formerly Maple Street); thence North 0°02' East 4.66 feet along the west line of 57th Avenue to a point, said point being North 42°02' East 10.00 feet from the southwesterly line of 55th Avenue; thence North 47°58' West 116.89 feet parallel to the southwesterly line of 55th Avenue to a point; thence South 42°02' West 10.00 feet to the point of beginning.

Containing 1,194.87 square feet.

Exhibit I

Vacated area of 55th Avenue (formerly Ash Street), Sweet Home, Oregon.

Related to property Map 13S01E27DC, Lot 600

A portion of land located in the Southwest $\frac{1}{4}$ of the Southeast $\frac{1}{4}$ of Section 27, Township 13 South, Range 1 East, Willamette Meridian, City of Sweet Home, Linn County, Oregon, more particularly described as follows:

Beginning at a point on the most northerly corner of Lot 5, Block 22, of the Scholl's Addition to Foster, Linn County, Oregon, a subdivision in the City of Sweet Home, Linn County, Oregon, said point also being on the southwesterly right-of-way of 55th Avenue; thence South 47°58' East 5.90 feet along the southwesterly line of 55th Avenue to the northeasterly corner of Lot 5, Block 22, of said subdivision, said point also being the intersection of the southwesterly line of 55th Avenue with the west right-of-way of 57th Avenue (formerly Maple Street); thence North 0°02' East 8.81 feet along the west line of 57th Avenue to a point, said point being North 42°02' East 6.54 feet from the most easterly corner of Lot 4, Block 22, of said subdivision; thence South 42°02' West 6.54 feet to the point of beginning

Containing 19.32 square feet.

Exhibit J

Vacated area of Locust Street (formerly Fifth Avenue), Sweet Home, Oregon.
Related to property Map 13S01E27DC, Lot 1000

A portion of land located in the Southwest $\frac{1}{4}$ of the Southeast $\frac{1}{4}$ of Section 27, Township 13 South, Range 1 East, Willamette Meridian, City of Sweet Home, Linn County, Oregon, more particularly described as follows:

Beginning at a point on the most northerly corner of Lot 11, Block 22, of the Scholl's Addition to Foster, Linn County, Oregon, a subdivision in the City of Sweet Home, Linn County, Oregon, said point also being on the southeasterly right-of-way of Locust Street; thence North $47^{\circ}58'$ West 30.00 feet to a point on the centerline of Locust Street; thence South $42^{\circ}02'$ West 100.00 feet along the centerline of Locust Street to a point, said point also being the intersection of the centerline of Locust Street with the northeasterly right-of-way of 54th Avenue (formally L Street); thence South $47^{\circ}58'$ East 30.00 feet along the northeasterly line of 54th Avenue to a point on the southeasterly line of Locust Street, said point also being the most westerly corner of Lot 11, Block 22, of said subdivision; thence North $42^{\circ}02'$ East 100.00 feet along the southeasterly line of Locust Street to the point of beginning.

Containing 3,000.00 square feet.

Exhibit K

Vacated area of Locust Street (formerly Fifth Street), Sweet Home, Oregon.
Related to property Map 13S01E27DB, Lot 04102

A portion of land located in the Northwest $\frac{1}{4}$ of the Southeast $\frac{1}{4}$ of Section 27, Township 13 South, Range 1 East, Willamette Meridian, City of Sweet Home, Linn County, Oregon, more particularly described as follows:

Beginning at a point on the most easterly corner of Lot 6, Block 19, of the Scholl's Addition to Foster, Linn County, Oregon, a subdivision in the City of Sweet Home, Linn County, Oregon, said point also being on the northwesterly right-of-way of Locust Street; thence South $47^{\circ}58'$ East 30.00 feet to a point on the centerline of Locust Street; thence South $42^{\circ}02'$ West 100.00 feet along the centerline of Locust Street to a point, said point also being the intersection of the centerline of Locust Street with the northeasterly right-of-way of 54th Avenue (formerly L Street); thence North $47^{\circ}58'$ West 30.00 feet along the northeasterly line of 54th Avenue to a point, said point being the most southerly corner of Lot 6, Block 19, of said subdivision; thence North $42^{\circ}02'$ East 100.00 feet along the northwesterly line of Locust Street to the point of beginning.

Containing 3,000 square feet.

Exhibit L

Vacated area of Locust Street (formerly Fifth Avenue), Sweet Home, Oregon.

Related to property Map 13S01E27DC, Lot 900

A portion of land located in the Southwest $\frac{1}{4}$ of the Southeast $\frac{1}{4}$ of Section 27, Township 13 South, Range 1 East, Willamette Meridian, City of Sweet Home, Linn County, Oregon, more particularly described as follows:

Beginning at a point on the most northerly corner of Lot 1, Block 22, of the Scholl's Addition to Foster, Linn County, Oregon, a subdivision in the City of Sweet Home, Linn County, Oregon, said point also being the intersection of the southwesterly right-of-way of 55th Avenue (formerly Ash Street) with the southeasterly right-of-way of Locust Street; thence South $42^{\circ}02'$ West 100.00 feet along the southeasterly line of Locust Street to a point, said point also being the most westerly corner of Lot 1, Block 22, of said subdivision; thence North $47^{\circ}58'$ West 30.00 feet to a point on the centerline of Locust Street; thence North $42^{\circ}02'$ East 100.00 feet along the centerline of Locust Street to a point, said point also being the intersection of the centerline of Locust Street with the southwesterly line of 55th Avenue; thence South $47^{\circ}58'$ East 30.00 feet along the southwesterly line of 55th Avenue to the point of beginning.

Containing 3,000.00 square feet.

Exhibit M

Vacated area of Locust Street (formerly Fifth Avenue), Sweet Home, Oregon.
Related to property Map 13S01E27DB, Lot 04101

A portion of land located in the Northwest $\frac{1}{4}$ of the Southeast $\frac{1}{4}$ of Section 27, Township 13 South, Range 1 East, Willamette Meridian, City of Sweet Home, Linn County, Oregon, more particularly described as follows:

Beginning at a point on the most easterly corner of Lot 5, Block 19, of the Scholl's Addition to Foster, Linn County, Oregon, a subdivision in the City of Sweet Home, Linn County, Oregon, said point also being at the intersection of the northwesterly right-of-way of Locust Street with the southwesterly right-of-way of 55th Avenue (formerly Ash Street); thence South $47^{\circ}58'$ East 30.00 feet along the southwesterly line of 55th Avenue to a point on the centerline of Locust Street; thence South $42^{\circ}02'$ West 100.00 feet along the centerline of Locust Street to a point; thence North $47^{\circ}58'$ West 30.00 feet to the most southerly corner of Lot 5, Block 19, of said subdivision; thence North $42^{\circ}02'$ East 100.00 feet along the northwesterly line of Locust Street to the point of beginning.

Containing 3,000.00 square feet.

Exhibit N

Vacated area of Larch Street (formerly Fourth Avenue), Sweet Home, Oregon.

Related to property Map 13S01E27DB, Lot 3400

A portion of land located in the Northwest $\frac{1}{4}$ of the Southeast $\frac{1}{4}$ of Section 27, Township 13 South, Range 1 East, Willamette Meridian, City of Sweet Home, Linn County, Oregon, more particularly described as follows:

Beginning at a point on the southeast corner of Lot 13, Block 17, of the Scholl's Addition to Foster, Linn County, Oregon, a subdivision in the City of Sweet Home, Linn County, Oregon, said point also being on the north right-of-way of Larch Street; thence South $76^{\circ}53'$ West 120.00 feet along the North line of Larch Street to a point, said point being the southwest corner of Lot 14, Block 17, of said subdivision, also being the intersection of the east right-of-way of 55th Avenue (formerly Ash Street) with the north line of Larch Street; thence South $13^{\circ}07'$ East 10.00 feet along the east line of 55th Avenue to a point, thence North $76^{\circ}53'$ East 120.00 feet parallel to the north line of Larch Street to a point; thence North $13^{\circ}07'$ West 10.00 feet to the point of beginning.

Containing 1200 square feet.

Exhibit O

Vacated area of Larch Street (formerly Fourth Avenue), Sweet Home, Oregon.

Related to property Map 13S01E27DB, Lot 3300

A portion of land located in the Northwest $\frac{1}{4}$ of the Southeast $\frac{1}{4}$ of Section 27, Township 13 South, Range 1 East, Willamette Meridian, City of Sweet Home, Linn County, Oregon, more particularly described as follows:

Beginning at a point on the southeast corner of Lot 12, Block 17, of the Scholl's Addition to Foster, Linn County, Oregon, a subdivision in the City of Sweet Home, Linn County, Oregon, said point also being on the north right-of-way of Larch Street; thence South $76^{\circ}53'$ West 60.00 feet along the north line of Larch Street to a point; said point being the southwest corner of Lot 12, Block 17 of said subdivision; thence South $13^{\circ}07'$ East 10.00 feet to a point, thence North $76^{\circ}53'$ East 60.00 feet parallel to the north line of Larch Street to a point; thence North $13^{\circ}07'$ West 10.00 feet to the point of beginning.

Containing 600 square feet.

Exhibit P

Vacated area of Larch Street (formerly Fourth Avenue), Sweet Home, Oregon.

Related to property Map 13S01E27DB, Lot 3200

A portion of land located in the Northwest $\frac{1}{4}$ of the Southeast $\frac{1}{4}$ of Section 27, Township 13 South, Range 1 East, Willamette Meridian, City of Sweet Home, Linn County, Oregon, more particularly described as follows:

Beginning at a point North $76^{\circ}53'$ East 20.00 feet from the southwest corner of Lot 10, Block 17, of the Scholl's Addition to Foster, Linn County, Oregon, a subdivision in the City of Sweet Home, Linn County, Oregon, said point also being on the north right-of-way of Larch Street; thence South $76^{\circ}53'$ West 80.00 feet along the North line of Larch Street to a point, said point being the southwest corner of Lot 11, Block 17, of said subdivision; thence South $13^{\circ}07'$ East 10.00 feet to a point, thence North $76^{\circ}53'$ East 80.00 feet parallel to the north line of Larch Street to a point; thence North $13^{\circ}07'$ West 10.00 feet to the point of beginning.

Containing 800 square feet.

Exhibit Q

Vacated area of Larch Street (formerly Fourth Avenue), Sweet Home, Oregon.

Related to property Map 13S01E27DB, Lot 3100

A portion of land located in the Northwest $\frac{1}{4}$ of the Southeast $\frac{1}{4}$ of Section 27, Township 13 South, Range 1 East, Willamette Meridian, City of Sweet Home, Linn County, Oregon, more particularly described as follows:

Beginning at a point on the southeast corner of Lot 9, Block 17, of the Scholl's Addition to Foster, Linn County, Oregon, a subdivision in the City of Sweet Home, Linn County, Oregon, said point also being at the intersection of the north right-of-way of Larch Street with the west right-of-way of 57th Avenue (formerly Maple Street); thence South $76^{\circ}53'$ West 106.27 feet along the north line of Larch Street to a point, said point being North $76^{\circ}53'$ East 20.00 feet from the southwest corner of Lot 10, Block 17, of said subdivision; thence South $13^{\circ}07'$ East 10.00 feet to a point, thence North $76^{\circ}53'$ East 103.92 feet parallel to the north line of Larch Street to a point, said point being on the west line of 57th Avenue; thence North $0^{\circ}02'$ East 10.27 feet along the west line of 57th Avenue to the point of beginning.

Containing 1050.92 square feet.

Exhibit R

Vacated area of Larch Street (formerly Fourth Avenue), Sweet Home, Oregon.

Related to property Map 13S01E27DB, Lot 3700

A portion of land located in the Northwest $\frac{1}{4}$ of the Southeast $\frac{1}{4}$ of Section 27, Township 13 South, Range 1 East, Willamette Meridian, City of Sweet Home, Linn County, Oregon, more particularly described as follows:

Beginning at a point on the northeast corner of Lot 5, Block 18, of the Scholl's Addition to Foster, Linn County, Oregon, a subdivision in the City of Sweet Home, Linn County, Oregon, said point also being at the intersection of the south right-of-way of Larch Street with the west right-of-way of 57th Avenue (formerly Maple Street); thence South $76^{\circ}53'$ West 155.64 feet along the south line of Larch Street to a point, said point being the northwest corner of Lot 4, Block 18, of said subdivision; thence North $13^{\circ}07'$ West 10 feet to a point; thence North $76^{\circ}53'$ East 157.98 feet parallel to the south line of Larch Street to a point, said point being on the west line of 57th Avenue; thence South $0^{\circ}02'$ West 10.27 feet along the west line of 57th Avenue to the point of beginning.

Containing 1567.90 square feet.

Exhibit S

Vacated area of Larch Street (formerly Fourth Avenue), Sweet Home, Oregon.

Related to property Map 13S01E27DB, Lot 3600

A portion of land located in the Northwest $\frac{1}{4}$ of the Southeast $\frac{1}{4}$ of Section 27, Township 13 South, Range 1 East, Willamette Meridian, City of Sweet Home, Linn County, Oregon, more particularly described as follows:

Beginning at a point on the northeast corner of Lot 3, Block 18, of the Scholl's Addition to Foster, Linn County, Oregon, a subdivision in the City of Sweet Home, Linn County, Oregon, said point also being on the south right-of-way of Larch Street; thence South $76^{\circ}53'$ West 60.00 feet along the south line of Larch Street to a point, said point being the northwest corner of Lot 3, Block 18, of said subdivision; thence North $13^{\circ}07'$ West 10.00 feet to a point; thence North $76^{\circ}53'$ East 60.00 feet parallel to the south line of Larch Street to a point; thence South $13^{\circ}07'$ East 10.00 feet to the point of beginning.

Containing 600 square feet.

Exhibit T

Vacated area of Larch Street (formerly Fourth Avenue), Sweet Home, Oregon.

Related to property Map 13S01E27DB, Lot 3601

A portion of land located in the Northwest $\frac{1}{4}$ of the Southeast $\frac{1}{4}$ of Section 27, Township 13 South, Range 1 East, Willamette Meridian, City of Sweet Home, Linn County, Oregon, more particularly described as follows:

Beginning at a point on the northeast corner of Lot 2, Block 18, of the Scholl's Addition to Foster, Linn County, Oregon, a subdivision in the City of Sweet Home, Linn County, Oregon, said point also being on the south right-of-way of Larch Street; thence South $76^{\circ}53'$ West 140.00 feet along the south line of Larch Street to a point, said point being the northwest corner of Lot 1, Block 18, of said subdivision; thence North $13^{\circ}07'$ West 10.00 feet parallel to the centerline of 55th Avenue (formerly Ash Street) north of Larch Street to a point; thence North $76^{\circ}53'$ East 140.00 feet parallel to the south line of Larch Street to a point; thence South $13^{\circ}07'$ East 10.00 feet to the point of beginning.

Containing 1400 square feet.

Exhibit U

Vacated area of 55th Avenue (formerly Ash Street), Sweet Home, Oregon.

Related to property Map 13S01E27DB, Lot 3601

A portion of land located in the Northwest $\frac{1}{4}$ of the Southeast $\frac{1}{4}$ of Section 27, Township 13 South, Range 1 East, Willamette Meridian, City of Sweet Home, Linn County, Oregon, more particularly described as follows:

Beginning at a point on the northwest corner of Lot 1, Block 18, of the Scholl's Addition to Foster, Linn County, Oregon, a subdivision in the City of Sweet Home, Linn County, Oregon, said point also being on the northeasterly right-of-way of 55th Avenue; thence South 47°58' East 178.48 feet along the northeasterly line of 55th Avenue to a point, said point being the most southerly corner of Lot 13, Block 18, of said subdivision; thence South 42°02' West 10.00 feet to a point; thence North 47°58' West 164.23 feet parallel to the northeasterly line of 55th Avenue to a point; thence North 13°07' West 17.36 feet parallel to the centerline of 55th Avenue north of Larch Street (formerly Fourth Avenue) to the point of beginning.

Containing 1706.52 square feet.

Exhibit V

Vacated area of 55th Avenue (formerly Ash Street), Sweet Home, Oregon.

Related to property Map 13S01E27DB, Lot 3606

A portion of land located in the Northwest $\frac{1}{4}$ of the Southeast $\frac{1}{4}$ of Section 27, Township 13 South, Range 1 East, Willamette Meridian, City of Sweet Home, Linn County, Oregon, more particularly described as follows:

Beginning at a point on the most westerly corner of Lot 12, Block 18, of the Scholl's Addition to Foster, Linn County, Oregon, a subdivision in the City of Sweet Home, Linn County, Oregon, said point also being on the northeasterly right-of-way of 55th Avenue; thence South 47°58' East 107.94 feet along the northeasterly line of 55th Avenue to a point, said point being the most southerly corner of Lot 11, Block 18, of said subdivision; thence South 42°02' West 10.00 feet to a point; thence North 47°58' West 107.94 feet parallel to the northeasterly line of 55th Avenue to a point; thence North 42°02' East 10.00 feet to the point of beginning.

Containing 1,078.90 square feet.

Exhibit W

Vacated area of 55th Avenue (formerly Ash Street), Sweet Home, Oregon.

Related to property Map 13S01E27DB, Lot 3603

A portion of land located in the Northwest $\frac{1}{4}$ of the Southeast $\frac{1}{4}$ of Section 27, Township 13 South, Range 1 East, Willamette Meridian, City of Sweet Home, Linn County, Oregon, more particularly described as follows:

Beginning at a point on the most westerly corner of Lot 10, Block 18, of the Scholl's Addition to Foster, Linn County, Oregon, a subdivision in the City of Sweet Home, Linn County, Oregon, said point also being on the northeasterly right-of-way of 55th Avenue; thence South 47°58' East 179.59 feet along the northeasterly line of 55th Avenue to a point, said point being the most southerly corner of Lot 9, Block 18, of said subdivision, and also being on the west right-of-way of 57th Avenue (formerly Maple Street); thence South 0°02' West 13.46 feet along the west line of 57th Avenue to a point, said point being also South 42°02' West 10.00 feet from the northeasterly line of 55th Avenue; thence North 47°58' West 188.52 feet parallel to the northeasterly line of 55th Avenue to a point; thence North 42°02' East 10.00 feet to the point of beginning.

Containing 1839.60 square feet.

Exhibit X

Vacated area of 54th Avenue (formerly L Street), Sweet Home, Oregon.

Related to property Map 13S01E27DB, Lot 04102

A portion of land located in the Northwest $\frac{1}{4}$ of the Southeast $\frac{1}{4}$ of Section 27, Township 13 South, Range 1 East, Willamette Meridian, City of Sweet Home, Linn County, Oregon, more particularly described as follows:

Beginning at a point on the most southerly corner of Lot 6, Block 19, of the Scholl's Addition to Foster, Linn County, Oregon, a subdivision in the City of Sweet Home, Linn County, Oregon, said point also being on the northeasterly right-of-way of 54th Avenue; thence North 47°58' West 120.00 feet along the northeasterly line of 54th Avenue to a point, said point being the most westerly corner of Lot 7, Block 19, of said subdivision; thence South 42°02' West 5.00 feet to a point; thence South 47°58' East 150.00 feet parallel to the northeasterly line of 54th Avenue to a point on the centerline of Locust Street (formerly Fifth Avenue); thence North 42°02' East 5.00 feet along the centerline of Locust Street to a point on the northeasterly line of 54th Avenue, thence North 47°58' West 30.00 feet along the northeasterly line of 54th Avenue to the point of beginning.

Containing 750 square feet.

Exhibit Y

Vacated area of 54th Avenue (formerly L Street), Sweet Home, Oregon.

Related to property Map 13S01E27DB, Lot 04103

A portion of land located in the Northwest $\frac{1}{4}$ of the Southeast $\frac{1}{4}$ of Section 27, Township 13 South, Range 1 East, Willamette Meridian, City of Sweet Home, Linn County, Oregon, more particularly described as follows:

Beginning at a point on the most southerly corner of Lot 8, Block 19, of the Scholl's Addition to Foster, Linn County, Oregon, a subdivision in the City of Sweet Home, Linn County, Oregon, said point also being on the northeasterly right-of-way of 54th Avenue; thence North 47°58' West 60.00 feet along the northeasterly line of 54th Avenue to a point, said point being the most southerly corner of Lot 9, Block 19, said subdivision; thence South 42°02' West 5.00 feet to a point; thence South 47°58' East 60.00 feet parallel to the northeasterly line of 54th Avenue to a point; thence North 42°02' East 5.00 feet to the point of beginning.

Containing 300 square feet.

Exhibit Z

Vacated area of 54th Avenue (formerly L Street), Sweet Home, Oregon.

Related to property Map 13S01E27DB, Lot 04300

A portion of land located in the Northwest $\frac{1}{4}$ of the Southeast $\frac{1}{4}$ of Section 27, Township 13 South, Range 1 East, Willamette Meridian, City of Sweet Home, Linn County, Oregon, more particularly described as follows:

Beginning at a point on the most southerly corner of Lot 9, Block 19, of the Scholl's Addition to Foster, Linn County, Oregon, a subdivision in the City of Sweet Home, Linn County, Oregon, said point also being on the northeasterly right-of-way of 54th Avenue; thence North 47°58' West 100.00 feet along the northeasterly line of 54th Avenue to a point; said point being North 47°58' West 40.00 feet from the most westerly corner of Lot 9, Block 19, of said subdivision; thence South 42°02' West 5.00 feet to a point; thence South 47°58' East 100.00 feet parallel to the northeasterly line of 54th Avenue to a point; thence North 42°02' East 5.00 feet to the point of beginning.

Containing 500 square feet.

Exhibit AA

Vacated area of 54th Avenue (formerly L Street), Sweet Home, Oregon.

Related to property Map 13S01E27DB, Lot 04301

A portion of land located in the Northwest $\frac{1}{4}$ of the Southeast $\frac{1}{4}$ of Section 27, Township 13 South, Range 1 East, Willamette Meridian, City of Sweet Home, Linn County, Oregon, more particularly described as follows:

Beginning at a point on the most westerly corner of Lot 11, Block 19, of the Scholl's Addition to Foster, Linn County, Oregon, a subdivision in the City of Sweet Home, Linn County, Oregon, said point also being at the intersection of the northeasterly right-of-way of 54th Avenue with the south right-of-way of Fourth Avenue (vacated); thence South $76^{\circ}53'$ West 36.55 feet along the northerly line of 54th Avenue to a point on the centerline of 54th Avenue, said line being the south line of the former Fourth Avenue (vacated); thence South $47^{\circ}58'$ East 56.05 feet along the centerline of 54th Avenue to a point, said point being North $42^{\circ}02'$ East 30.00 feet from the most easterly corner of Lot 1, Block 20, of said subdivision; thence North $42^{\circ}02'$ East 25.00 feet to a point, said point being South $42^{\circ}02'$ West 5.00 feet from the northeasterly line of 54th Avenue; thence South $47^{\circ}58'$ East 80.00 feet parallel to the northeasterly line of 54th Avenue to a point, said point being North $47^{\circ}58'$ West 40.00 feet and South $42^{\circ}02'$ West 5.00 feet from the most westerly corner of Lot 9, Block 19, of said subdivision; thence North $42^{\circ}02'$ East 5.00 feet to a point on the northeasterly line of 54th Avenue; thence North $47^{\circ}58'$ West 115.17 feet along the northeasterly line of 54th Avenue to the point of beginning.

Containing 1769.14 square feet.

Exhibit AB

Vacated area of 54th Avenue (formerly L Street), Sweet Home, Oregon.

Related to property Map 13S01E27DB, Lot 4400

A portion of land located in the Northwest $\frac{1}{4}$ of the Southeast $\frac{1}{4}$ of Section 27, Township 13 South, Range 1 East, Willamette Meridian, City of Sweet Home, Linn County, Oregon, more particularly described as follows:

Beginning at a point on the most northerly corner of Lot 1, Block 20, of the Scholl's Addition to Foster, Linn County, Oregon, a subdivision in the City of Sweet Home, Linn County, Oregon, said point also being the intersection of the southwesterly right-of-way of 54th Avenue with the south right-of-way of Fourth Avenue (vacated); thence North 76°53' East 36.55 feet along the northerly line of 54th Avenue to a point on the centerline of 54th Avenue, thence South 47°58' East 56.05 feet along the centerline of 54th Avenue to a point; thence South 42°02' West 30.00 feet to a point on the southwesterly line of 54th Avenue, said point being the most easterly corner of Lot 1, Block 20, of said subdivision; thence North 47°58' West 76.93 feet along the west line of 54th Avenue to the point of beginning.

Containing 1996.33 square feet.

Exhibit AC

Vacated area of 54th Avenue (formerly L Street), Sweet Home, Oregon.
Related to property Map 13S01E27DB, Lot 04801

A portion of land located in the Northwest $\frac{1}{4}$ of the Southeast $\frac{1}{4}$ of Section 27, Township 13 South, Range 1 East, Willamette Meridian, City of Sweet Home, Linn County, Oregon, more particularly described as follows:

Beginning at a point on the most easterly corner of Lot 4, Block 20, of the Scholl's Addition to Foster, Linn County, Oregon, a subdivision in the City of Sweet Home, Linn County, Oregon, said point also being on the southwesterly right-of-way of 54th Avenue; thence North 47°58' West 120.00 feet along the southwesterly line of 54th Avenue to a point, said point being the most northerly corner of Lot 3, Block 20 of said subdivision; thence North 42°02' East 15.00 feet to a point; thence South 47°58' East 120.00 feet parallel to the southwesterly line of 54th Avenue to a point; thence South 42°02' West 15.00 feet to the point of beginning.

Containing 1,800 square feet.

Exhibit AD

Vacated area of 54th Avenue (formerly L Street), Sweet Home, Oregon.

Related to property Map 13S01E27DB, Lot 04800

A portion of land located in the Northwest $\frac{1}{4}$ of the Southeast $\frac{1}{4}$ of Section 27, Township 13 South, Range 1 East, Willamette Meridian, City of Sweet Home, Linn County, Oregon, more particularly described as follows:

Beginning at a point on the most easterly corner of Lot 8, Block 20, of the Scholl's Addition to Foster, Linn County, Oregon, a subdivision in the City of Sweet Home, Linn County, Oregon, said point also being at the intersection of the southwesterly right-of-way of 54th Avenue and the northwesterly right-of-way of Locust Street (formerly Fifth Avenue); thence North $47^{\circ}58'$ West 240.00 feet along the southwesterly line of 54th Avenue to a point, said point being the most northerly corner of Lot 5, Block 20 of said subdivision; thence North $42^{\circ}02'$ East 15.00 feet to a point; thence South $47^{\circ}58'$ East 240.00 feet parallel to the southwesterly line of 54th Avenue to a point on the northwesterly line of Locust Street; thence South $42^{\circ}02'$ West 15.00 feet along the northwesterly line of Locust Street to the point of beginning.

Containing 3,600 square feet.