

ORDINANCE BILL NO. 3 FOR 2003

ORDINANCE NO. 1149

AN ORDINANCE VACATING PUBLIC RIGHT-OF-WAY PORTIONS OF 9TH AVENUE FROM POPLAR STREET TO THE NORTH END TERMINUS ABUTTED BY THOSE PROPERTIES ON ASSESSOR'S MAP 13-1E-31BA TAX LOTS 2900, 2950, 3100, 3300, 3500, AND 3600, ALL WITHIN THE CITY OF SWEET HOME.

WHEREAS, the City Council has initiated the vacation proceeding on its own motion, and has made notice provided, as required by ORS Chapter 271; and,

WHEREAS, the Planning Commission of the City of Sweet Home has considered these matters in a public hearing held on June 2, 2003, as provided by law, and has recommended to the City Council that the Vacations be approved as hereinafter provided; and,

WHEREAS, no objections have been received to said proposed vacations; and,

WHEREAS, no substantial effect to the market value of the properties has been identified; and,

WHEREAS, the City Council held a public hearing on this matter on June 10, 2003.

NOW, THEREFORE, THE CITY OF SWEET HOME, DOES ORDAIN AS FOLLOWS:

Section 1. Street Vacation.

That the following legal descriptions of the public right-of-way abutting the subject properties as identified below with Assessor Map Page / Tax Lot and as depicted on map titled "N. 9th Avenue Vacation Attachment "A" ", are vacated:

Area 1: 131E31BA/2900; Beginning at a point on the West line of 9th Avenue which is North 89°56' West 253.00 feet and North 0°11' West 115.70 feet from the Southeast corner of Government Lot 2 in Section 31, Township 13 South, Range 1 East of the Willamette Meridian, in Sweet Home, Linn County, Oregon; thence North 19°49' East 87.37 feet more or less to a point, said point being on the center line of 9th Avenue; thence North 0°11' West 116.91 feet more or less along the centerline of said 9th Avenue to a point on the North line of 9th Avenue; thence North 89°56' West 30 feet along the North line of 9th Avenue to a point on the East line of 9th Avenue, said point being the Northwest corner of 9th Avenue; thence South 0°11' East 199.01 feet more or less along the West line of 9th Avenue to the point of beginning, containing 0.109 acres.

Area 2: 131E31BA/2950; Beginning at a point on the North line of 9th Avenue which is North 89°56' West 193.00 feet and North 0°11' West 314.00 feet more or less from the Southeast corner of Government Lot 2 in Section 31, Township 13 South, Range 1 East of the Willamette Meridian, in Sweet Home, Linn County, Oregon, said point being the Northeast corner of 9th Avenue; thence North 89°56' West 30 feet to a point on the North line of said 9th Avenue, said point being on the center line of 9th Avenue; thence South 0°11' East 38.30 feet along the center line of 9th Avenue to a point; thence South 89°56' East 30 feet to a point on the East line of 9th Avenue; thence North 0°11' West 38.30 feet along the East line of said 9th Avenue to the point of beginning, containing 0.026 acres.

Area 3: 131E31BA/3100; Beginning at a point on the East line of 9th Avenue which is North 89°56' West 193.00 feet and North 0°11' West 115.70 feet from the Southeast corner of Government Lot 2 in Section 31, Township 13 South, Range 1 East of the Willamette Meridian, in Sweet Home, Linn County, Oregon; thence North 0°11' West 85.00 feet along the East line of said 9th Avenue to a point; thence South 13°04' West 87.22 feet to a point North 89°56' West 20 feet from said beginning point; thence South 89°56' East 20 feet to the point of beginning, containing 0.019 acres, and subject to the continuation in centerline alignment, terms and conditions therein of a Water and Sewer Line Easement particularly described and recorded in Volume 1207, Page 225, Linn County, Oregon Microfilm Records.

Area 4: 131E31BA/3300; Beginning at a point on the East line of 9th Avenue which is North 89°56' West 193.00 feet and North 0°11' West 65.70 feet from the Southeast corner of Government Lot 2 in Section 31, Township 13 South, Range 1 East of the Willamette Meridian, in Sweet Home, Linn County, Oregon; thence North 0°11' West 50 feet along the East line of said 9th Avenue; thence North 89°56' West 20 feet; thence South 0°11' East 50 feet; thence South 89°56' East 20 feet to the point of beginning, containing 0.023 acres.

Area 5: 131E31BA/3500; Beginning at a point on the East line of 9th Avenue which is North 89°56' West 193.00 feet and North 0°11' West 15 feet from the Southeast corner of Government Lot 2 in Section 31, Township 13 South, Range 1 East of the Willamette Meridian, in Sweet Home, Linn County, Oregon; thence North 0°11' West 50.70 feet along the East line of said 9th Avenue; thence North 89°56' West 20 feet; thence South 0°11' East 50.70 feet; thence South 89°56' East 20 feet to the point of beginning, containing 0.023 acres.

Area 6: 131E31BA/3600; Beginning at a point on the East line of 9th Avenue which is North 89°56' West 193.00 feet from the Southeast corner of Government Lot 2 in Section 31, Township 13 South, Range 1 East of the Willamette Meridian, in Sweet Home, Linn County, Oregon; thence North 0°11' West 15 feet along the East line of said 9th Avenue; thence North 89°56' West 20 feet; thence South 0°11' East 15 feet to a point on the East line of the 40 foot right-of-way portion of 9th Avenue; thence South 89°56' East 20 feet to the point of beginning, containing 0.007 acres.

Section 2. The City recorder shall file with the County Recorder a certified copy of this ordinance, with copies also filed with the County Assessor and County Surveyor, as required by ORS Chapter 271.

PASSED by the Council and approved by the Mayor this 8th day of July, 2003

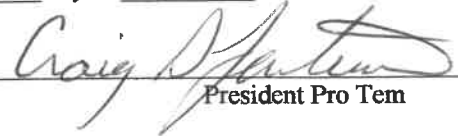

President Pro Tem

ATTEST:

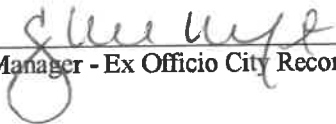

City Manager - Ex Officio City Recorder

After recording, return to: City of Sweet Home, 1140 12th Avenue, Sweet Home, OR 97386

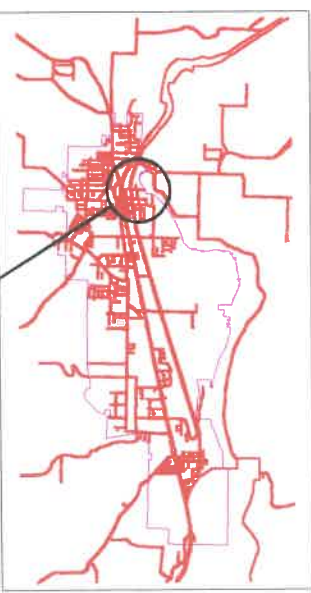
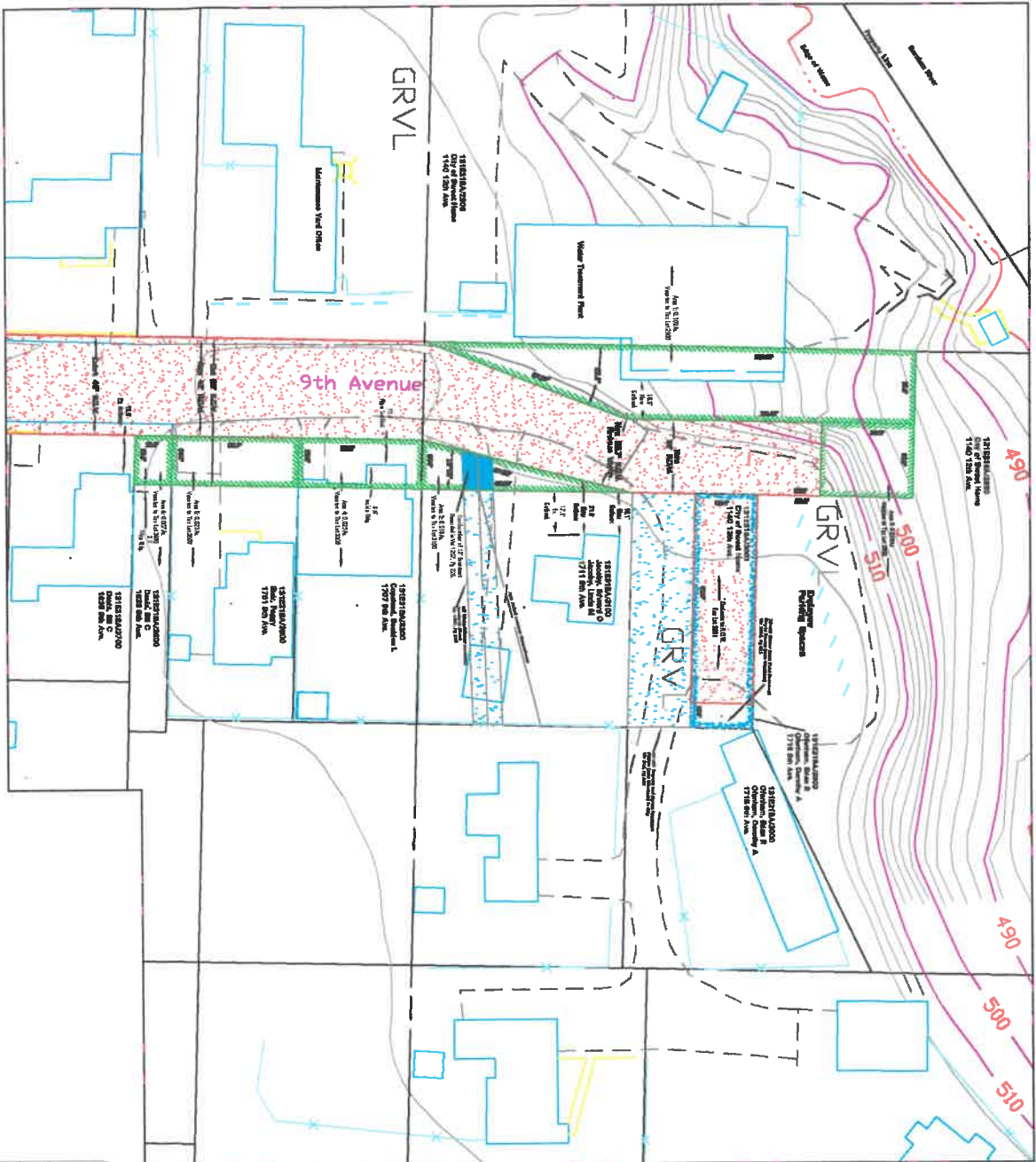

Property Listing

Area	Owner	Address	Tax Id.	Area Vacated
1	City Sweet Home	1440 12th Ave	2800	0.109 ac.
2	City Sweet Home	1440 12th Ave	2850	0.029 ac.
3	Jacey	1711 9th Ave	3100	0.019 ac.
4	Copeland	1707 9th Ave	3300	0.023 ac.
5	Blair	1701 9th Ave	3500	0.023 ac.
6	Dalks	1635 9th Ave	3800	0.007 ac.

Legend

- Right-of-Way Vacation Boundary
- Public / Private Easements
- Public Right-of-Way
- Edge of Gravel
- Elevation Contours
- Parking Curb

City of Sweet Home
 N. 9th Avenue Vacation
 Attachment 'A'

7.183
 N 1 E
 Section 01, T46N, R14E

PROJECT NO. 1
 DATE: 1/1/2017
 TITLE: N. 9th Avenue Vacation Attachment 'A'

DESIGNER: [Name]
 CHECKER: [Name]
 APPROVER: [Name]

DATE: 1/1/2017
 SHEET NO. 1 OF 3

LETTER OF CERTIFICATION

STATE OF OREGON)
)
County of Linn)

I, Charlene Adams, of the City of Sweet Home Planning Office, do personally certify that the enclosed document is a true copy of Ordinance number 1150 vacating public right-of-way portions of 59th Avenue from Nandina Street to Main Street (South Santiam Highway, US Highway 20) abutted by those properties on Assessor's Map 13-1E-27DA, Tax Lots 500 and 1408, all within the City of Sweet Home, File Number V 03-2.

Charlene Adams
Charlene Adams

Subscribed and sworn to before me this 10th day of July, 2003

Carol Lewis
Carol Lewis
Notary Public for Oregon

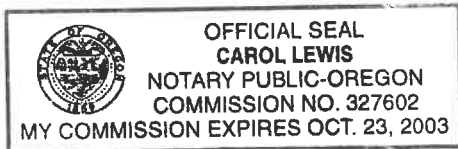

My Commission Expires: 10-23-03

STATE OF OREGON
County of Linn

I hereby certify that the attached was received and duly recorded by me in Linn County records.

STEVE DRUCKENMILLER
Linn County Clerk

By [Signature], Deputy

M
R 20
S 10
A 11
O
MF 1456
PAGE 654

8:30 O'clock a.m. 41
JUL 21 2003